

# Threaded Fittings

	<p><b>RMT085</b> STAINLESS STEEL PIPE CURVE F-F BSP</p> <p>Sizes:</p> <table border="1"> <tr> <td>3/8"</td> <td>1/2"</td> <td>3/4"</td> </tr> </table>	3/8"	1/2"	3/4"		<p><b>RMT090</b> STAINLESS STEEL FEM-FEM ELBOW 90°. BSP</p> <p>Sizes:</p> <table border="1"> <tr> <td>1/8"</td> <td>1/4"</td> <td>3/8"</td> <td>1/2"</td> </tr> <tr> <td>3/4"</td> <td>1"</td> <td>1.1/4"</td> <td>1.1/2"</td> </tr> <tr> <td>2"</td> <td>2.1/2"</td> <td>3"</td> <td>4"</td> </tr> </table>	1/8"	1/4"	3/8"	1/2"	3/4"	1"	1.1/4"	1.1/2"	2"	2.1/2"	3"	4"																
3/8"	1/2"	3/4"																																
1/8"	1/4"	3/8"	1/2"																															
3/4"	1"	1.1/4"	1.1/2"																															
2"	2.1/2"	3"	4"																															
	<p><b>RMT092</b> STAINLESS STEEL MALE-FEM ELBOW 90°. BSP</p> <p>Sizes:</p> <table border="1"> <tr> <td>1/8"</td> <td>1/4"</td> <td>3/8"</td> <td>1/2"</td> </tr> <tr> <td>3/4"</td> <td>1"</td> <td>1.1/4"</td> <td>1.1/2"</td> </tr> <tr> <td>2"</td> <td>2.1/2"</td> <td>3"</td> <td>4"</td> </tr> </table>	1/8"	1/4"	3/8"	1/2"	3/4"	1"	1.1/4"	1.1/2"	2"	2.1/2"	3"	4"		<p><b>RMT121</b> STAINLESS STEEL FEM-FEM ELBOW 45°. BSP</p> <p>Sizes:</p> <table border="1"> <tr> <td>1/8"</td> <td>1/4"</td> <td>3/8"</td> <td>1/2"</td> </tr> <tr> <td>3/4"</td> <td>1"</td> <td>1.1/4"</td> <td>1.1/2"</td> </tr> <tr> <td>2"</td> <td>2.1/2"</td> <td>3"</td> <td>4"</td> </tr> </table>	1/8"	1/4"	3/8"	1/2"	3/4"	1"	1.1/4"	1.1/2"	2"	2.1/2"	3"	4"							
1/8"	1/4"	3/8"	1/2"																															
3/4"	1"	1.1/4"	1.1/2"																															
2"	2.1/2"	3"	4"																															
1/8"	1/4"	3/8"	1/2"																															
3/4"	1"	1.1/4"	1.1/2"																															
2"	2.1/2"	3"	4"																															
	<p><b>RMT131</b> STAINLESS STEEL FEMALE TEE. BSP</p> <p>Sizes:</p> <table border="1"> <tr> <td>1/8"</td> <td>1/4"</td> <td>3/8"</td> <td>1/2"</td> </tr> <tr> <td>3/4"</td> <td>1"</td> <td>1.1/4"</td> <td>1.1/2"</td> </tr> <tr> <td>2"</td> <td>2.1/2"</td> <td>3"</td> <td>4"</td> </tr> </table>	1/8"	1/4"	3/8"	1/2"	3/4"	1"	1.1/4"	1.1/2"	2"	2.1/2"	3"	4"		<p><b>RMT132</b> STAINLESS STEEL FEMALE REDUCE TEE BSP.</p> <p>Sizes:</p> <table border="1"> <tr> <td>1" &gt; 3/4"</td> </tr> </table>	1" > 3/4"																		
1/8"	1/4"	3/8"	1/2"																															
3/4"	1"	1.1/4"	1.1/2"																															
2"	2.1/2"	3"	4"																															
1" > 3/4"																																		
	<p><b>RMT140</b> STAINLESS STEEL F-F REDUCE SOCKET. BSP</p> <p>Sizes:</p> <table border="1"> <tr> <td>1/4" &gt; 1/8"</td> <td>3/8" &gt; 1/4"</td> <td>1/2" &gt; 3/8"</td> <td>3/4" &gt; 1/2"</td> </tr> <tr> <td>1" &gt; 3/4"</td> <td>1.1/4" &gt; 1"</td> <td>1.1/2" &gt; 1"</td> <td>1.1/2" &gt; 1.1/4"</td> </tr> <tr> <td>2" &gt; 1.1/2"</td> </tr> </table>	1/4" > 1/8"	3/8" > 1/4"	1/2" > 3/8"	3/4" > 1/2"	1" > 3/4"	1.1/4" > 1"	1.1/2" > 1"	1.1/2" > 1.1/4"	2" > 1.1/2"		<p><b>RMT141</b> STAINLESS STEEL M-F REDUCE BUSH. BSP</p> <p>Sizes:</p> <table border="1"> <tr> <td>1/4" &gt; 1/8"</td> <td>3/8" &gt; 1/8"</td> <td>3/8" &gt; 1/4"</td> <td>1/2" &gt; 1/4"</td> </tr> <tr> <td>1/2" &gt; 3/8"</td> <td>3/4" &gt; 3/8"</td> <td>3/4" &gt; 1/2"</td> <td>1" &gt; 1/2"</td> </tr> <tr> <td>1" &gt; 3/4"</td> <td>1.1/4" &gt; 1/2"</td> <td>1.1/4" &gt; 3/4"</td> <td>1.1/4" &gt; 1"</td> </tr> <tr> <td>1.1/2" &gt; 3/4"</td> <td>1.1/2" &gt; 1"</td> <td>1.1/2" &gt; 1.1/4"</td> <td>2" &gt; 1"</td> </tr> <tr> <td>2" &gt; 1.1/4"</td> <td>2" &gt; 1.1/2"</td> <td>2.1/2" &gt; 1.1/2"</td> <td>2.1/2" &gt; 2"</td> </tr> <tr> <td>3" &gt; 2"</td> <td>3" &gt; 2.1/2"</td> </tr> </table>	1/4" > 1/8"	3/8" > 1/8"	3/8" > 1/4"	1/2" > 1/4"	1/2" > 3/8"	3/4" > 3/8"	3/4" > 1/2"	1" > 1/2"	1" > 3/4"	1.1/4" > 1/2"	1.1/4" > 3/4"	1.1/4" > 1"	1.1/2" > 3/4"	1.1/2" > 1"	1.1/2" > 1.1/4"	2" > 1"	2" > 1.1/4"	2" > 1.1/2"	2.1/2" > 1.1/2"	2.1/2" > 2"	3" > 2"	3" > 2.1/2"
1/4" > 1/8"	3/8" > 1/4"	1/2" > 3/8"	3/4" > 1/2"																															
1" > 3/4"	1.1/4" > 1"	1.1/2" > 1"	1.1/2" > 1.1/4"																															
2" > 1.1/2"																																		
1/4" > 1/8"	3/8" > 1/8"	3/8" > 1/4"	1/2" > 1/4"																															
1/2" > 3/8"	3/4" > 3/8"	3/4" > 1/2"	1" > 1/2"																															
1" > 3/4"	1.1/4" > 1/2"	1.1/4" > 3/4"	1.1/4" > 1"																															
1.1/2" > 3/4"	1.1/2" > 1"	1.1/2" > 1.1/4"	2" > 1"																															
2" > 1.1/4"	2" > 1.1/2"	2.1/2" > 1.1/2"	2.1/2" > 2"																															
3" > 2"	3" > 2.1/2"																																	

# Threaded Fittings



<b>RMT145</b> STAINLESS STEEL M-M REDUCE NIPPLE BSP			
Sizes:			
1/4">1/8"	3/8">1/8"	3/8">1/4"	1/2">1/4"
1/2">3/8"	3/4">3/8"	3/4">1/2"	1">1/2"
1">3/4"	1.1/4">1/2"	1.1/4">3/4"	1.1/4">1"
1.1/2">3/4"	1.1/2">1"	1.1/2">1.1/4"	2">1"
2">1.1/4"	2">1.1/2"		



<b>RMT146</b> STAINLESS STEEL MALE-FEM SOCKET. BSP			
Sizes:			
1/4">1/8"	3/8">1/4"	3/8">3/8"	1/2">1/4"
1/2">3/8"	1/2">1/2"	3/4">1/2"	3/4">3/4"
1">1/2"	1">3/4"	1">1"	1.1/4">1"
1.1/2">1"	1.1/2">1.1/4"	2">1"	2">1.1/2"

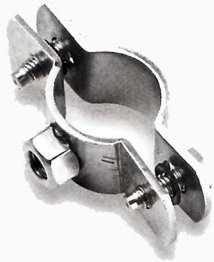

<b>RMT156</b> STAINLESS STEEL PIPE COLLAR ONLY			
Sizes:			
3/8"	1/2"	3/4"	1"
1.1/4"	1.1/2"	2"	2.1/2"
3"	3.1/2"	4"	5"
6"	8"		

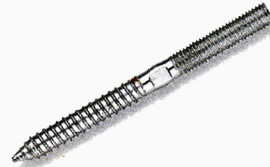

<b>RMT158</b> STAINLESS STEEL SCREW FOR PIPE COLLAR	
Sizes:	
M8X100	M10X120



<b>RMT168</b> STAINLESS STEEL HALF SOCKET. BSP			
Sizes:			
1/8"	1/4"	3/8"	1/2"
3/4"	1"	1.1/4"	1.1/2"
2"	2.1/2"	3"	



<b>RMT180</b> STAINLESS STEEL FEMALE CROSS BSP.			
Sizes:			
1/8"	1/4"	3/8"	1/2"
3/4"	1"	1.1/4"	1.1/2"
2"			



<b>RMT268</b> STAINLESS STEEL SOCKET. BSP			
Sizes:			
1/8"	1/4"	3/8"	1/2"
3/4"	1"	1.1/4"	1.1/2"
2"	2.1/2"	3"	4"

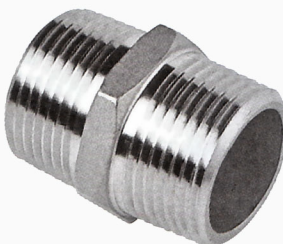

<b>RMT280</b> STAINLESS STEEL HEXAGON NIPPLE. BSP			
Sizes:			
1/8"	1/4"	3/8"	1/2"
3/4"	1"	1.1/4"	1.1/2"
2"	2.1/2"	3"	4"

# Threaded Fittings

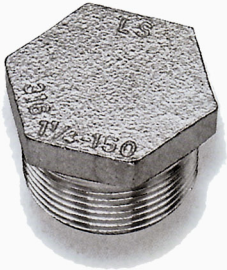

**RMT292**  
STAINLESS STEEL HEXAGON PLUG  
BSP

Sizes:

1/8"	1/4"	3/8"	1/2"
3/4"	1"	1.1/4"	1.1/2"
2"	2.1/2"	3"	



**RMT300**  
STAINLESS STEEL HEXAGON CAP.  
BSP

Sizes:

1/8"	1/4"	3/8"	1/2"
3/4"	1"	1.1/4"	1.1/2"
2"			

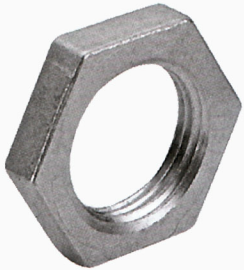

**RMT310**  
STAINLESS STEEL BACK NUT BSP

Sizes:

1/8"	1/4"	3/8"	1/2"
3/4"	1"	1.1/4"	1.1/2"
2"			



**RMT330**  
STAINLESS STEEL FEMALE FEMALE  
UNION BSP

Sizes:

1/8"	1/4"	3/8"	1/2"
3/4"	1"	1.1/4"	1.1/2"
2"			



**RMT340**  
STAINLESS STEEL UNION FOR  
WELDING. BSP

Sizes:

1/8"	1/4"	3/8"	1/2"
3/4"	1"	1.1/4"	1.1/2"
2"			

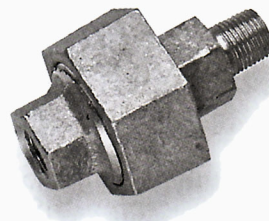

**RMT341**  
STAINLESS STEEL MALE-FEMALE  
UNION BSP.

Sizes:

1/8"	1/4"	3/8"	1/2"
3/4"	1"	1.1/4"	1.1/2"
2"			

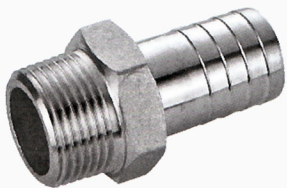

**RMT344**  
STAINLESS STEEL HOSE NIPPLE BSP

Sizes:

1/8"X7MM	1/4"X9MM	3/8"X11MM	1/2"X13MM
3/4"X16MM	1"X25MM	1.1/4"X33MM	1.1/2"X40MM
2"X51MM			



**RMT530**  
STAINLESS STEEL EXTENSION  
SCREW. BSP

Sizes:

1/8"	1/4"	3/8"	1/2"
3/4"	1"	1.1/4"	1.1/2"
2"			

# Threaded Fittings



<b>RMT531</b> STAINLESS STEEL SIMPLE NIPPLE BSP			
Sizes:			
1/8"	1/4"	3/8"	1/2"
3/4"	1"	1.1/4"	1.1/2"
2"			



<b>RMT600</b> STAINLESS STEEL BUSH / STUB END. BSP			
Sizes:			
1/8"	1/4"	3/8"	1/2"
3/4"	1"	1.1/4"	1.1/2"
2"	2.1/2"	3"	4"



<b>RMT800</b> STAINLESS STEEL WELDABLE ENDS BSP			
Sizes:			
1/2"	3/4"	30MM	1"
40MM	1.1/4"	1.1/2"	50MM
2"	2.1/2"X2MM	2.1/2"X3MM	3"
3.1/2"	4"	129MM	5"
154MM	168MM	8"	